

The  
**OASIS**  
**GRAND 14**  
Facing Eiffel Tower & Park

مركز  
الرياض  
للخدمات  
العقارية

**Downtown**  
DHA Raya Concept

A Project of



# THE OASIS

GRAND 14

**Facing  
Park,  
Fountains  
& Eiffel  
Tower**

Booking From  
**20%**  
Rate/Sqft  
~~19,000~~  
**18,000**







## Walking Distance

Parks &  
Fountains



Eiffel  
Tower



Theme  
Park



Sports  
Complex



Imtiaz  
Mega Mall



Grand X  
Luxury Shopping  
Mall



## 5 Minutes From

Ring  
Road



Canal  
Road



Winter  
Land



Grand  
Mosque



Beaconhouse  
School



Bahria  
International  
Hospital



*Signature* **Inventory**  
 Rate Sqt ~~19,000~~ **18,000**

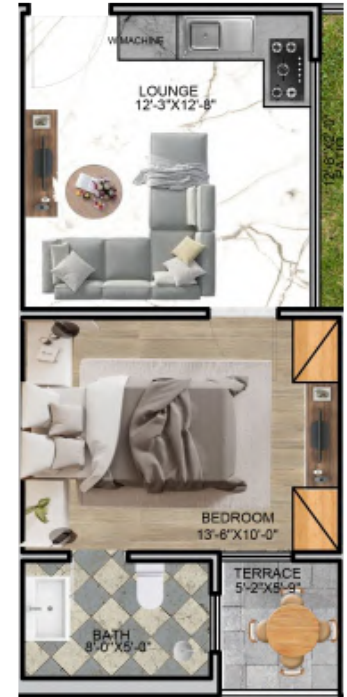

**500 Sqft**

**Luxury 1 Bed Apartment**  
 Facing Eiffel Tower Park & Fountains

Gross Sqft	20% Booking	20% Confirmation	36 Installments	Total
500	1,800,000	1,800,000	150,000	9,000,000
515	1,854,000	1,854,000	154,500	9,270,000
525	1,890,000	1,890,000	157,500	9,450,000
532	1,915,200	1,915,200	159,600	9,576,000
540	1,944,000	1,944,000	162,000	9,720,000
550	1,980,000	1,980,000	165,000	9,900,000

**Note: Facing Fountains & RAYA Concept units come with a premium of 10% additional charges.**



**1 Bed**  
Luxury Apartment

**1 Bed** TV Lounge

**1 Bed** Kitchen



**1 Bed** Bath



The OASIS  
GRAND 14  
Facing Eiffel Tower & Park



**1 Bed** Terrace  
Park & Eiffel View

# Signature Inventory

Rate  
Sqft ~~19,000~~ **18,000**

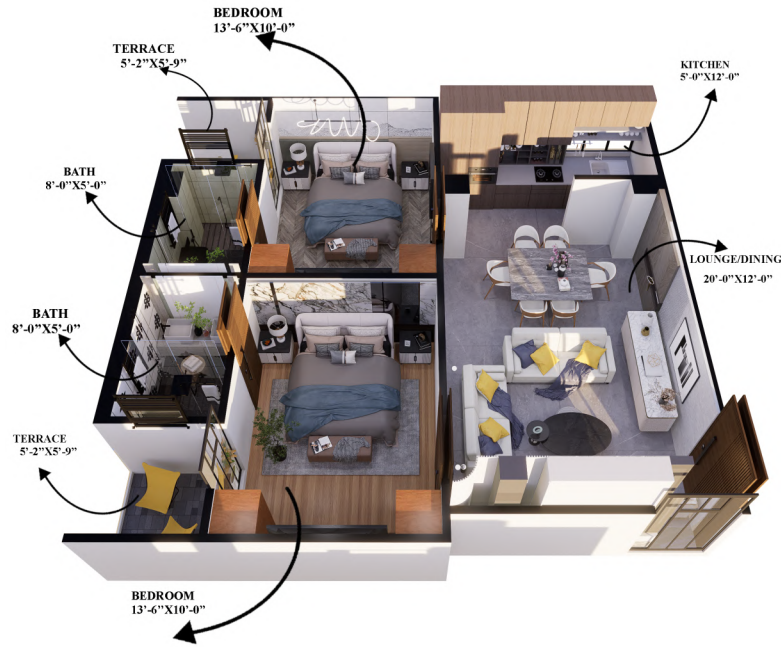

## Luxury 2 Bed Apartment

Facing Eiffel Tower Park & Fountains

Gross Sqft	20% Booking	20% Confirmation	36 Installments	Total
1,000	3,600,000	3,600,000	300,000	18,000,000

Note: Facing Fountains & RAYA Concept units come with a premium of 10% additional charges.

**2 Bed** – Room 1  
Luxury Apartment



**2 Bed** – Room 2  
Luxury Apartment





**2 Bed** TV Lounge

**2 Bed**  
Dining & Kitchen



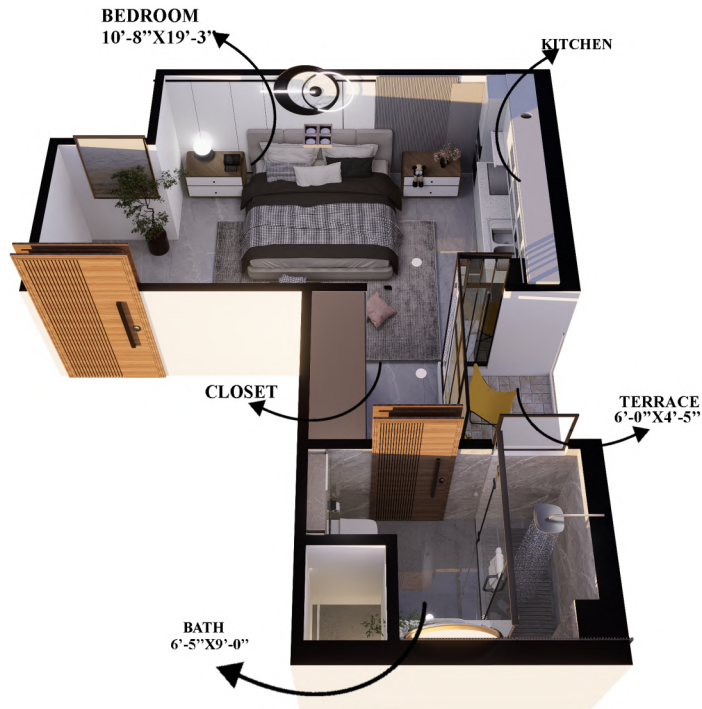

Rate ~~19,000~~ **18,000**



## Luxury Studio Apartments

Facing Eiffel Tower Park & Fountains

Gross Sqft	20% Booking	20% Confirmation	36 Installments	Total
360	1,296,000	1,296,000	108,000	6,480,000
365	1,314,000	1,314,000	109,500	6,570,000
375	1,350,000	1,350,000	112,500	6,750,000
380	1,368,000	1,368,000	114,000	6,840,000
400	1,440,000	1,440,000	120,000	7,200,000
420	1,512,000	1,512,000	126,000	7,560,000

**Note: Facing Fountains & RAYA Concept units come with a premium of 10% additional charges.**

**Studio**  
Luxury Apartment



**Studio** Bath

**Studio** Terrace  
Park & Eiffel View



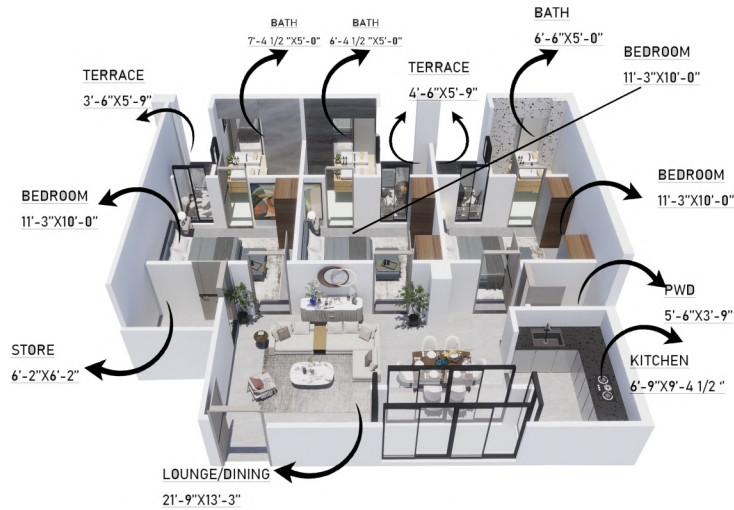

## Luxury 3 Bed Apartment Facing Eiffel Tower

Gross Sqft	20% Booking	20% Confirmation	36 Installments	Total
1,500	5,400,000	5,400,000	450,000	27,000,000



# Rooftop



A Project of



We Commit, **We Deliver**

